

NEW WATERDOWN ELEMENTARY SCHOOL DETAILS

SCHOOL DETAILS

New Building

- Capacity- 504 Pupil Places
- 4 Full Day Kindergarten Classrooms
- 18 Classrooms

Child Care

- Birth to 3.8 Program
 - 5 rooms- 1 Infant, 2 Toddler, 2 Preschool
 - Operator selection through procurement process. Planned for 2026-2027 school year
- Before and After School Program
 - Same operator as Birth to 3.8 program
 - Expand programming in Waterdown by 88 spaces
 - HWDSB and operator to project program size
 - Apply for service once operator is selected



Waterdown Elementary School

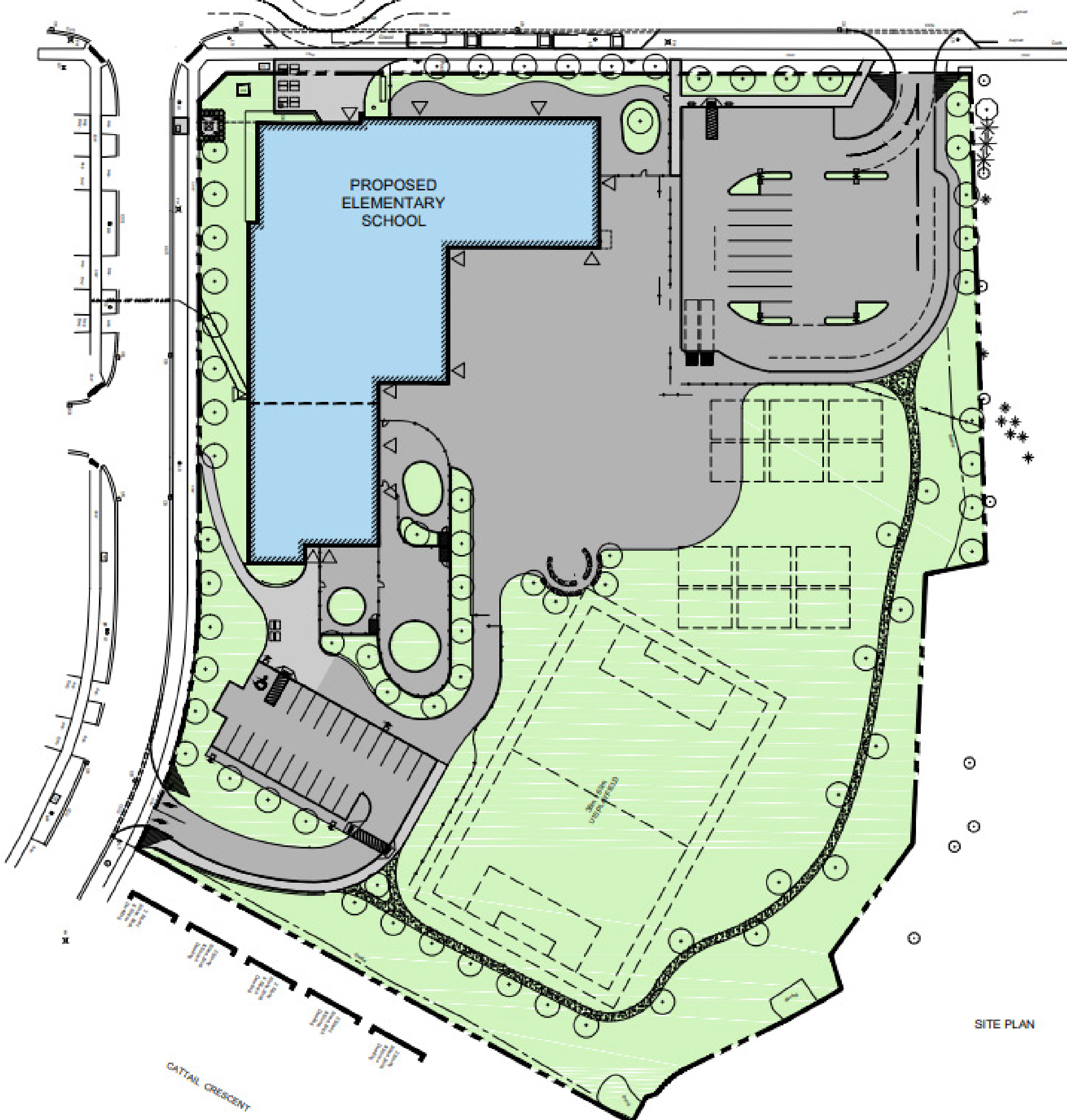

Waterdown Elementary School

